

**RUDRAKSH
CLUB & RESORT
AT UJJAIN**

ARCHITECT

INTERIOR ARCHITECT

**1/2" DIA PIPE RUNNING BELOW
FALSE CEILING LVL
AT + 94" HT FROM FFL**

**1/2" DIA PIPE RUNNING BELOW
FALSE CEILING LVL
AT + 94" HT FROM FFL**

**FALSE CEILING
AT + 96" HT.**

**1/2" DIA PIPE RUNNING BELOW
FALSE CEILING LVL
AT + 94" HT FROM FFL**

WALL 15

**FALSE CEILING
AT + 96" HT.**

**1/2" DIA AUDCO
BALL VALVE
AT + 8" HT FROM FFL**

**1/2" DIA PIPE
AT + 8" HT FROM FFL**

**1/2" DIA DOWN TAKE
GAS PIPE
UPTO + 8" HT FROM FFL**

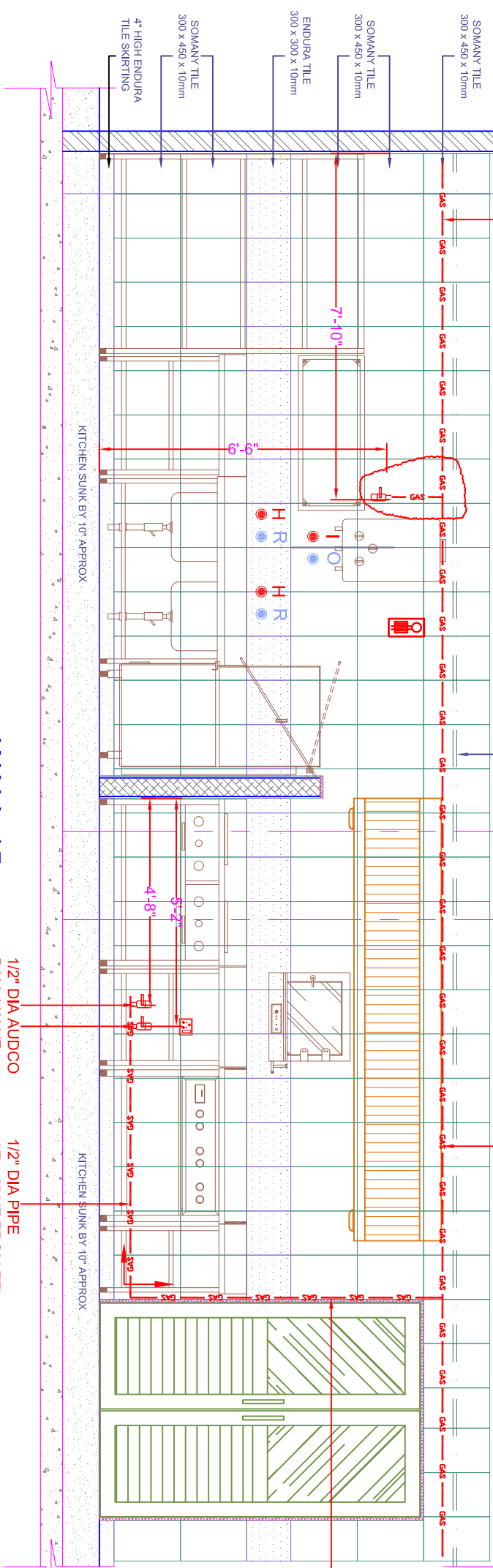

**FALSE CEILING
AT + 96" HT.**

WALL 16

**18mm THK
BLACK GRANITE**

**SS CORNER
PROTECTOR**

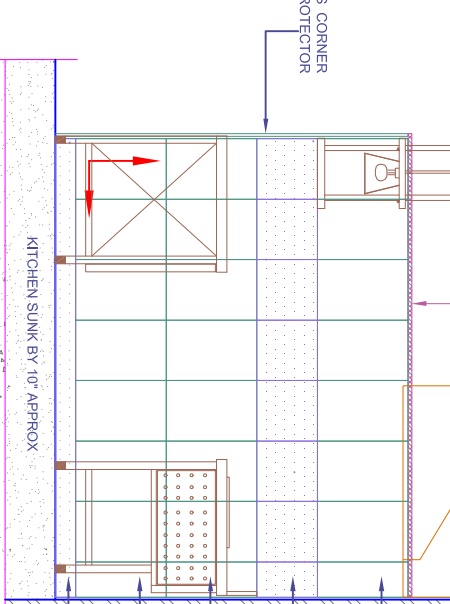

WALL 17

**18mm THK
BLACK GRANITE**

**SS CORNER
PROTECTOR**

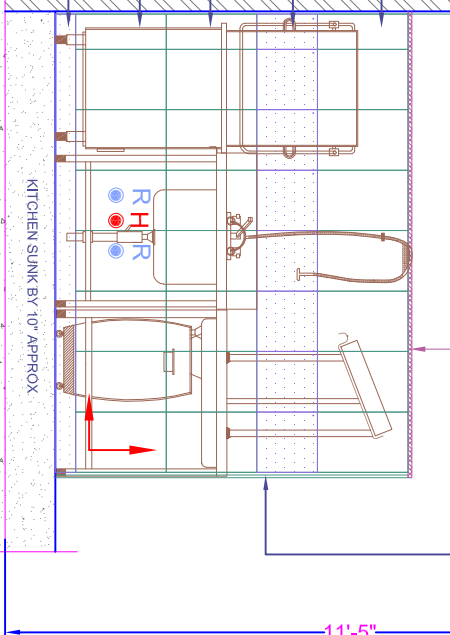

PROJECT NO :- 3S - RCRU - 28 - 00.	
SHEET TITLE PROPOSED ALA-CARTE KITCHEN WALL ELEVATION.	
BUILD #	SHEET NUMBER
3S - RCRU - GFAK - 13 / D.	01.
DATE	SCALE
27 / 08 / 2016	DRAWN
	SHIWEETA
	CHECKED
	SANJEV
© 3S INTERIOR DESIGN. All Rights Reserved	
NO PART OF THE CONTENTS OF THIS DOCUMENT MAY BE REPRODUCED OR TRANSMITTED IN ANY FORM OR BY ANY MEANS WITHOUT THE WRITTEN PERMISSION OF 3S INTERIOR DESIGN.	

3S KITCHEN DESIGN
F & B Planner & Designer
403, 4th FLOOR, TRINITY SKYLINE, JRD CENTER RD,
OPP. ANANDI MANSION, BOHVALI, ET,
UJJAIN, M.P. INDIA
TEL: +91 9607869772
EMAIL: PROJECT@3SKITCHENDESIGN.COM
WEB: 3SKITCHENDESIGN.COM

KITCHEN CONSULTANT

MEP CONSULTANT

CLIENT